

MU 911-X/...

Colinear 4 dB Mobile Antenna for the 900 MHz Band

DESCRIPTION

- Encapsulated phasing coil.
- Black-chromed stainless steel whip.
- 3 models, type "l", "m" and "h", cover band segments suiting the most common 900 MHz CELLULAR networks such as EAMPS, ETACS, NMT-900 and EGSM.
- Stainless steel X-mount with M6-thread whip-fastening system.
- Simple mounting exclusively with access from the outside.
- Models available with X-mount (oblong), CX-mount (circular) and MM-mount (magnetic).
- Choice between two connection principles:
 - X-mount, MM-mount: FME-connection (supplied without cable).
 - XP4-mount: Permanently attached 4 m low loss cable terminated with FME-connector.



All whips are compatible with all mounts.

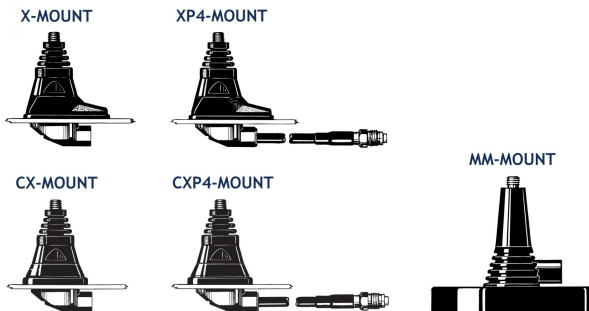

To help selecting the correct model for a specific cellular network please consult the survey of cellular network frequencies under USEFUL DATA in our catalogues.

ORDERING DESIGNATIONS

TYPE	PRODUCT NO.	FREQUENCY	MOUNT VERSION
MU 911-X/l	130001238	824 - 894 MHz (EAMPS)	X-mount (oblong) with FME-system
MU 911-X/m	130001242	872 - 950 MHz (ETACS)	
MU 911-X/h	130001508	880 - 960 MHz (EGSM & NMT-900)	
MU 911-CX/l	130001239	824 - 894 MHz (EAMPS)	CX-mount (circular) with FME-system
MU 911-CX/m	130001243	872 - 950 MHz (ETACS)	
MU 911-CX/h	130001233	880 - 960 MHz (EGSM & NMT-900)	
MU 911-XP4/l	130001240	824 - 894 MHz (EAMPS)	XP4-mount (oblong) with 4 m cable + FME-connector
MU 911-XP4/m	130001244	872 - 950 MHz (ETACS)	
MU 911-XP4/h	130001234	880 - 960 MHz (EGSM & NMT-900)	
MU 911-CXP4/l	130001241	824 - 894 MHz (EAMPS)	CXP4-mount (circular) with 4 m cable + FME-connector
MU 911-CXP4/m	130001245	872 - 950 MHz (ETACS)	
MU 911-CXP4/h	130001235	880 - 960 MHz (EGSM & NMT-900)	
MU 911-MM/l	130001509	824 - 894 MHz (EAMPS)	MM-mount (magnetic) with FME-system
MU 911-MM/m	130001510	872 - 950 MHz (ETACS)	
MU 911-MM/h	130001511	880 - 960 MHz (EGSM & NMT-900)	

SPECIFICATIONS

ELECTRICAL	
MODEL	MU 911-X/...
ANTENNA TYPE	Collinear mobile antenna
FREQUENCY	900 MHz-band covered by three models
IMPEDANCE	Nom. 50 Ω
POLARIZATION	Vertical
GAIN	4 dB (acc. to EIA RS-329-1)
BANDWIDTH	≥ 50 MHz @ SWR ≤ 1.5 ≥ 90 MHz @ SWR ≤ 2.0
SWR	≤ 1.3 @ f. res.
MAX. POWER	60 W
MECHANICAL	
MATERIALS	Whip: Stainless steel and brass, black-chromed Durable plastics Mount: Black-chromed brass Weather- and shockproof plastics Stainless steel
RECOMMENDED INSTALLATION TORQUE	4 ± 1 Nm
COLOUR	Black
HEIGHT	Approx. 32 cm
WEIGHT	X-version: Approx. 80 g XP4-version: Approx. 220 g MM-version: Approx. 280 g
MOUNTING	18 mm dia. hole

INSTALLATION

This antenna should be mounted in the car roof to ensure best omnidirectional coverage.



10/06/11

Mounting can take place exclusively with access from the outside when drilling an 18 mm dia. hole. Mounting can take place from the inside by drilling a 14 mm dia. hole. When mounting in a 14 mm dia. hole, remove the bottom plastic ring of the packing gasket with a sharp cutter.

When cleaning the car in car-washing machines, remove the whip using a spanner, size 9 mm. After wash, refit the whip and tighten it lightly with the spanner.

As the X- and CX-mounts are internally equipped with a bendable section, the antenna can always be adjusted to an upright position independent of the tilt angle of the installation spot (up to 30° tilt).

The MiniMag (abbreviated: MM) is a small, light-weight magnetic mount with a high attaching effect. A silicone layer applied to the contact surface protects the car roof and ensures maximum friction.

Antennas with magnetic mount should be mounted at the centre of the vehicle roof to ensure best omnidirectional coverage.

1. INSTALLATION DIMENSIONS

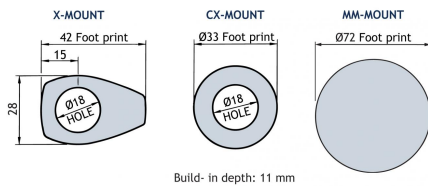

2. INSTALLATION STEPS

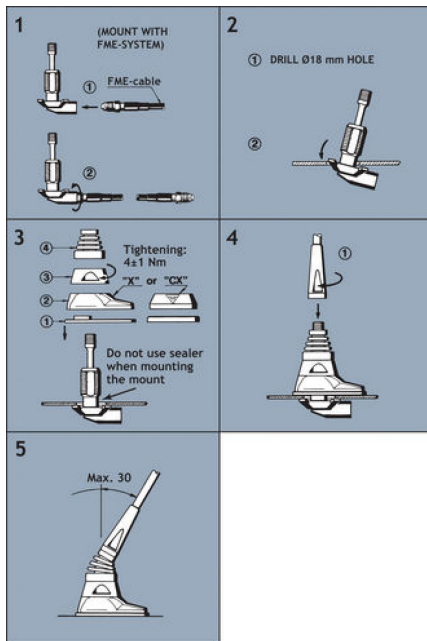

Do not use sealer on rubber gasket or other places.

3. TUNING

The antenna is delivered factory-tuned and requires no further tuning.

PLEASE NOTE

For safety reasons

1. When using the MU 911-MM/..., car speed must not exceed 140 km/h.
2. If operating the MM-mount with other whips, whip length must never exceed 60 cm, and utilizing this maximum length, car speed must not exceed 115 km/h.

PROCOM France S.A.R.L. se réserve le droit d'améliorer les spécifications sans préavis.