

HX 30-KZ

Very Short Helical Mobile Antenna for the 27 MHz CB-Band

DESCRIPTION

- Ultra-short (0.03λ) mobile antenna for short-distance communication.
- Ideal where normal-sized antennas cannot be used, as on building-site machines, forest vehicles etc.
- Amazingly good performance despite a very low height, due to top loading.
- Stainless steel Z-mount with ball-joint and wing screw whip-fastening system.
- Simple mounting exclusively with access from the outside. Models with roof thickness from 2 mm to 7.5 mm mounting from the inside.
- Ready-tuned and tested from the factory to assure minimum SWR.
- Choice between two connection principles:
 - Z-mount: FME-connection (supplied without cable).
 - ZP4-mount: Permanently attached 4 m cable terminated with FME-connector.

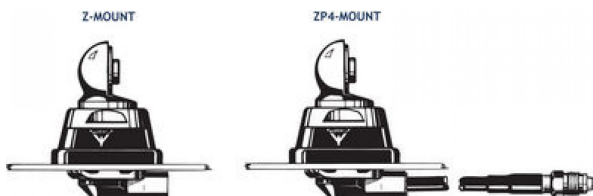
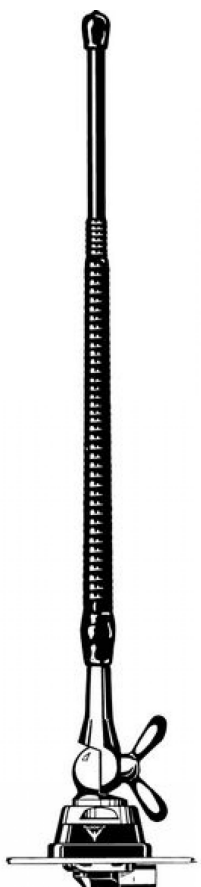

ORDERING DESIGNATIONS

TYPE	PRODUCT NO.	MOUNT VERSION
HX 30-KZ	130000599	Z-mount with FME-system
HX 30-KZP4	130000600	ZP4-mount with 4 m cable and FME connector

SPECIFICATIONS

ELECTRICAL	
MODEL	HX 30-KZ
ANTENNA TYPE	Toploaded helical mobile antenna
FREQUENCY	27 MHz CB-band
IMPEDANCE	Nom. 50 Ω
POLARISATION	Vertical
BAND WIDTH	≥ 250 kHz @ SWR ≤ 2.0
SWR	≤ 1.3 @ f. res.
MAX. POWER	5 W
MECHANICAL	
MATERIALS	Whip: Electroplated steel helix moulded in elastomer Chromed brass Mount: Chromed brass Weather- and shockproof plastics Stainless steel
RECOMMENDED INSTALLATION TORQUE	7.5 \pm 1 Nm
COLOUR	Black
HEIGHT	Approx. 34 cm
WEIGHT	Approx. 330 g
MOUNTING	$\varnothing 21$ mm dia. hole (For roof thickness 2 mm up to 7.5 mm mounting hole should be $\varnothing 22$ mm dia.)
ROOF THICKNESS	Max. 2.0 mm (Models up to 7.5 mm on request)

INSTALLATION

This antenna is provided with type Z-mount. The whip is fastened to the mount by means of our standard ball-joint and wing screw system. The adjustable ball-joint ensures that the whip can always be mounted in a vertical position independent of the angle of the installation spot.

The Z-mount is particularly well suited for mounting on car-roofs because of its ability to be installed exclusively with access from the outside. The Z-Mount for roof thickness from 2 mm to 7.5 mm must be mounted from the inside. However, the antenna can be installed anywhere on the car, as the Z-mount is equally well suited for mounting on e.g. trunk or wing.

1. INSTALLATION DIMENSIONS

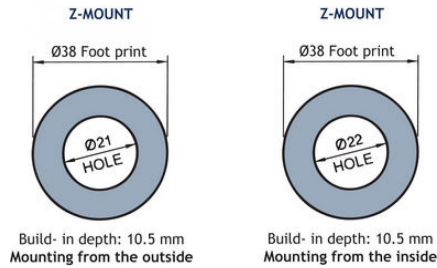

2. INSTALLATION STEPS

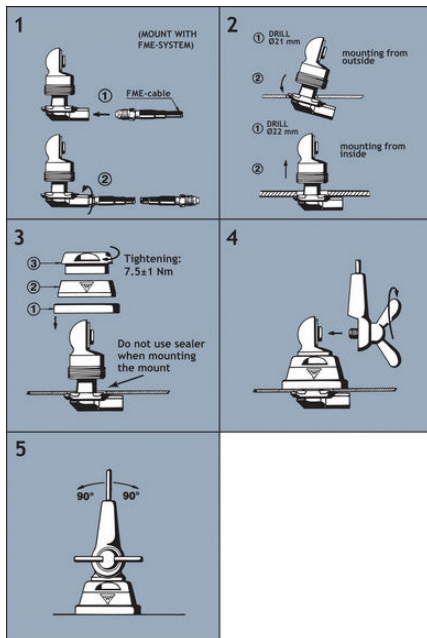

Do not use sealer on rubber gasket or other places.

3. TUNING

The antenna is factory-tuned for minimum SWR. No additional tuning is required.



PROCOM France S.A.R.L. se réserve le droit d'améliorer les spécifications sans préavis.
05/07/11