

GPS-C UMTS

GPS Antenna with a 1/4 λ Mobile Antenna for the UMTS Band

DESCRIPTION

- External antenna whip mounted on the GPS-Combi mount.
 - Mobile antenna for the UMTS band.
 - Black-chromed whip in nice, discrete design.
 - Easily removable whip for car wash.
- GPS-antenna for fixed installations.
 - Full hemispherical coverage.
 - Built-in high gain, low noise amplifier.
 - Right-Hand Circular Polarisation (RHCP).
 - 5 V supply voltage (3 V respectively 12 V available on request).
 - DC supply via RF-connector.

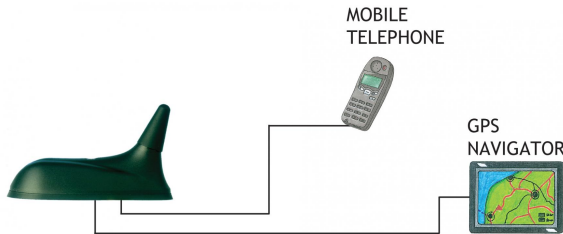

ORDERING DESIGNATIONS

TYPE NO.	PRODUCT NO.
GPS-C UMTS	132000081

SPECIFICATIONS FOR WHIP

ELECTRICAL	
MODEL	GPS-C UMTS
ANTENNA TYPE	1/4 λ mobile antenna
FREQUENCY	1900–2200 MHz (UMTS)
IMPEDANCE	Nom. 50 Ω
POLARISATION	Vertical
BANDWIDTH	≥ 300 MHz @ SWR ≤ 2.25
SWR	≤ 1.3 @ f. res.
GAIN	Approx. 0 dB (acc. to EIA RS-329-1)
MAX. POWER	25 W
MECHANICAL	
MATERIALS	Black-chromed brass
COLOUR	Black
HEIGHT	Approx. 25 mm
WEIGHT	Approx. 16 g
MOUNTING	On the GPS-Combi mount

SPECIFICATIONS FOR GPS-COMBI MOUNT

ELECTRICAL GENERAL SPECIFICATIONS	
MODEL	GPS-COMBI MOUNT
ANTENNA TYPE	Active patch antenna
FREQUENCY	1575 MHz (DCS)
IMPEDANCE	Nom. 50 Ω
POLARISATION	Circular right-hand
COVERAGE	Hemispherical
GAIN	28 dBic in axial direction (typ.)
CROSS-POLARISATION ATT.	> 10 dB (typ.)
SELECTIVITY	> 45 dB down at ± 45 MHz
BUILT-IN AMPLIFIER	
GAIN	> 30 dB (typ.)
NOISE FIGURE	< 1 dB (typ.)
P 1dB	Approx. +7 dBm
SWR (output)	≤ 2.0
SUPPLY VOLTAGE	5 ± 0.5 VDC (3 V resp. 12 V on request)
CURRENT CONSUMPTION	Approx. 25 mA
MECHANICAL (ONLY FOR THE GPS-PART)	
MATERIALS	Cu-nite brass Stainless steel Reinforced thermoplastic
ANTENNA COLOUR	Black
TEMP. RANGE	-35° C → +75° C
CONNECTOR	FME (male for GPS) + FME (female for mobile antenna)
RECOMMENDED INSTALL. TORQUE	4 ± 0.5 Nm
DIMENSIONS(H x L)	Approx. 30 x 89 mm
ROOF THICKNESS	Max. 2.5 mm
WEIGHT	Approx. 114 g
MOUNTING	ø18.0 mm dia. hole for roof thickness up to 2.0 mm ø18.5 mm dia hole for roof thickness 2.0 - 2.5 mm Tools for mounting included

MOUNTING INSTRUCTIONS

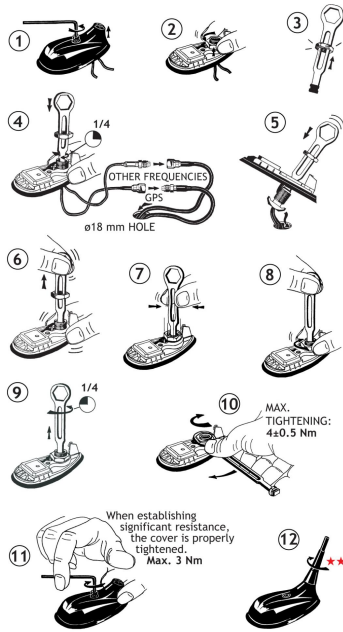

★★ The whip should always be dismantled during car wash.

Do not use sealer on rubber gasket or other places.

CABLE MOUNTING

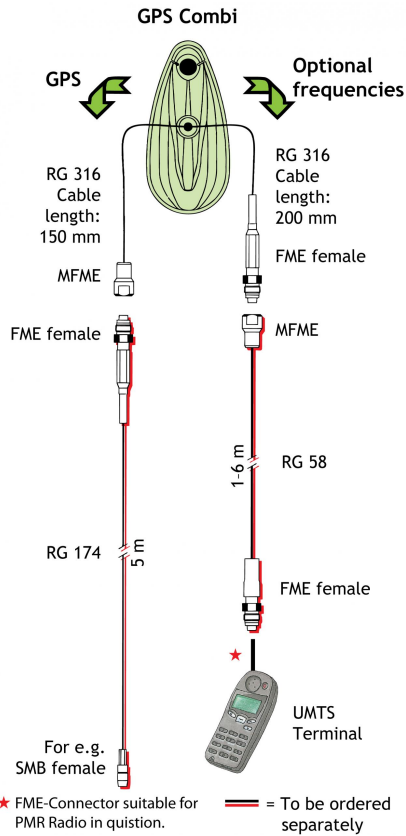

TYPICAL RESPONSE CURVES

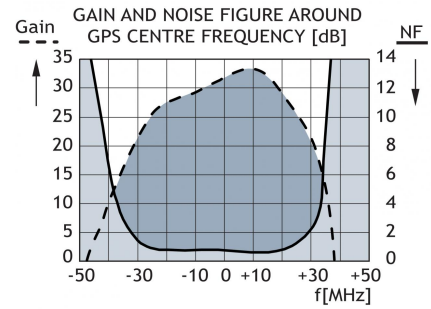
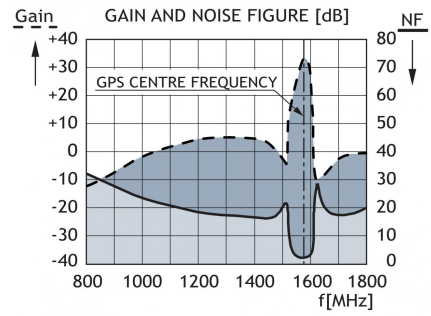

VERTICAL RADIATION PATTERN

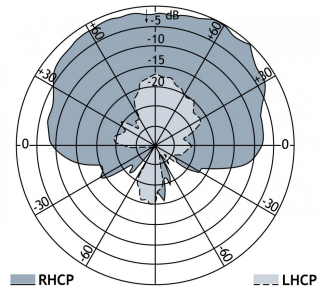

PROCOM France S.A.R.L. se réserve le droit d'améliorer les spécifications sans préavis.
12/11/13