

GPS-C FLEX/TETRA/GSM

Unity Gain $\frac{1}{4} \lambda$ Mobile Antenna for the TETRA and EGSM Band

DESCRIPTION

- External antenna whip mounted on the GPS-Combi mount.
 - Flexible antenna made of steel wire covered with black silicone tubing.
 - Easily removable for car wash.
- GPS-antenna for fixed installations.
 - Full hemispherical coverage.
 - Built-in high gain, low noise amplifier.
 - Right-Hand Circularly Polarized antenna (RHCP).
 - 5 V supply voltage (3 V respectively 12 V available on request).
 - DC supply via RF-connector.

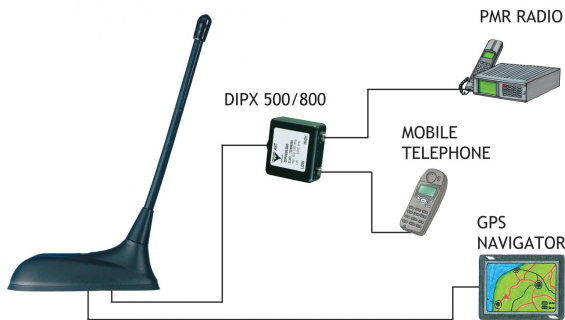

ORDERING DESIGNATIONS

TYPE	PRODUCT NO.	ROOF THICKNESS
GPS-C FLEX/TETRA/GSM	132000066	Max. 2.5 mm
GPS-C FLEX/TETRA/GSM/7mm	132000069	3.5 - 7.5 mm

SPECIFICATIONS FOR WHIP

ELECTRICAL	
MODEL	GPS-C FLEX/TETRA/GSM
ANTENNA TYPE	$\frac{1}{4} \lambda$ mobile antenna
FREQUENCY	380 – 430 MHz (TETRA) 880 – 960 MHz (EGSM)
IMPEDANCE	Nom. 50 Ω
POLARIZATION	Vertical
GAIN	0 dB (acc. to EIA RS-329-1) for the TETRA band
BANDWIDTH	≥ 50 MHz @ SWR ≤ 2.5
SWR	≤ 1.7 @ f.res.
MAX. POWER	25 W
MECHANICAL	
MATERIALS	Silicone tube over flexible bowden wire Chromed brass
COLOUR	Black
HEIGHT	Approx. 140 mm
WEIGHT	Approx. 25 g
MOUNTING	On the GPS-Combi mount

SPECIFICATIONS FOR GPS-COMBI MOUNT

ELECTRICAL GENERAL SPECIFICATIONS	
MODEL	GPS-COMBI MOUNT
ANTENNA TYPE	Active patch antenna
FREQUENCY	1575 MHz
IMPEDANCE	Nom. 50 Ω
POLARIZATION	Circular right-hand
COVERAGE	Hemispherical
GAIN	28 dBic in axial direction (typ.)
CROSS-POLARIZATION ATT.	> 10 dB (typ.)
SELECTIVITY	> 45 dB down @ ± 45 MHz
BUILT-IN AMPLIFIER	
GAIN	> 30 dB (typ.)
NOISE FIGURE	< 1 dB (typ.)
P _{1dB}	Approx. +7 dBm
SWR (output)	≤ 2.0
SUPPLY VOLTAGE	5 \pm 0.5 VDC (3 V resp. 12 V on request)
CURRENT CONSUMPTION	Approx. 25 mA
MECHANICAL (ONLY FOR THE GPS-PART)	
MATERIALS	Cu-nite brass Stainless steel Reinforced thermoplastic
ANTENNA COLOUR	Black
TEMP. RANGE	-35° C \rightarrow +75° C
CONNECTOR	FME (male for GPS) + FME (female for mobile antenna)
RECOMMENDED INSTALL. TORQUE	4 \pm 0.5 Nm
DIMENSIONS (H x L)	Approx. 30 x 89 mm
ROOF THICKNESS	Max. 2.5 mm or 3.5 - 7.5 mm
WEIGHT	Approx. 114 g
MOUNTING	\varnothing 18.0 mm dia. hole for roof thickness up to 2.0 mm \varnothing 18.5 mm dia. hole for roof thickness 2.0 - 2.5 mm \varnothing 19.0 mm dia. hole for roof thickness 3.5 - 7.5 mm Tools for mounting included

MOUNTING INSTRUCTIONS

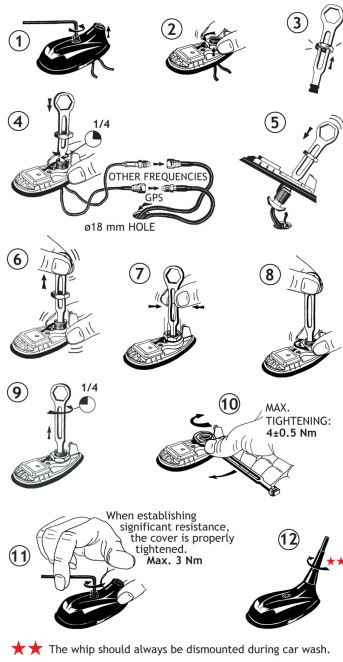

TYPICAL RESPONSE CURVES

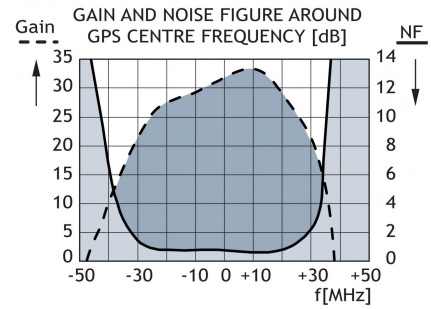
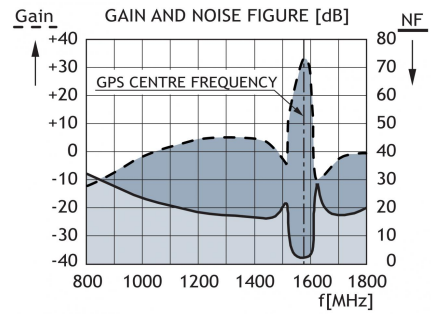

CABLE MOUNTING

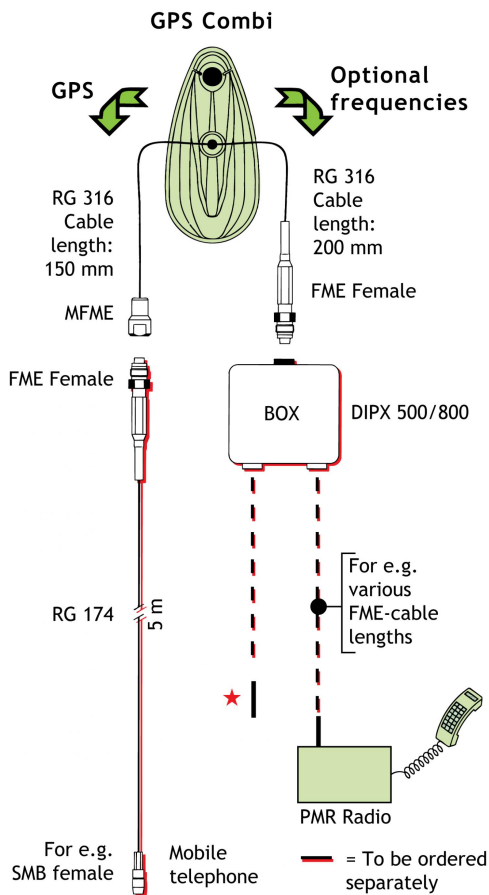

VERTICAL RADIATION PATTERN

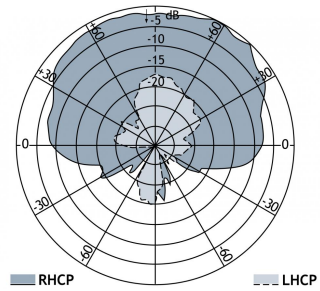

PROCOM France S.A.R.L. se réserve le droit d'améliorer les spécifications sans préavis.
23/08/13

★ FME-Connector suitable for Mobile telephone in question.